

TOKYO KEIKI INC.Fluid Power & Systems Control Co.
Overseas Sales Sect., Sales Dept.**Announcement of Design Change of DG4V-5 Series**

Dear Distributors and Valued Customers,

Thank you for your daily support for Tokyo Keiki's hydraulic products.

We would like to announce the design change of the DG4V-5 series solenoid operated directional control valves, due to renewal of the casting mold of the body. This not only led to a change in appearance of the valve, but to the change of dimensions of certain points of the body as well.

The design number will be updated from "40" to "50". Details are indicated herein, but please refer to your relevant contacts for further information and assistance.

Sincerely,

【Outline】

- The body of the DG4V-5 series will change due to the renewal of the casting mold.
- The mounting bolt will be 5mm shorter than the current "40" designs, as the fitting surface of the body is designed to be 5mm lower (mounting bolt for single stack will be changed from M6×40 to M6×35)
- The new design number is "50".

【Applicable Model Codes】

(F3)-DG4V-5-**(L)-M-*(*)-***-40-(*)	→	(F3)-DG4V-5-**(L)-M-*(*)-***-50-(*)
(F3)-DG4VS-5-**(L)-M-*(*)-***-40-(*)	→	(F3)-DG4VS-5-**(L)-M-*(*)-***-50-(*)
(F3)-DG4VC-5-**(L)-M-P(*)-H-7-40-(*)	→	(F3)-DG4VC-5-**(L)-M-P(*)-H-7-50-(*)
(F3)-DG4VL-5-**(L)-M-P(*)-H-7-40-(*)	→	(F3)-DG4VL-5-**(L)-M-P(*)-H-7-50-(*)
(F3)-DG4VF-5-**(L)-M-P(*)-H-7-40-(*)	→	(F3)-DG4VF-5-**(L)-M-P(*)-H-7-50-(*)

【Points of Modification】

- Modification will apply to DG4V-5, DG4VS-5, DG4VC-5, DG4VL-5, and DG4VF-5 series.
- Points of modification are listed below. Please find details described in each section.
 - 1) Change of mounting bolt length.
 - 2) Change of body's surface treatment, from machined surface to casting surface.
 - 3) Removal of sticker on body.
 - 4) Change position of ground screw hole for the conduit box.
 - 5) Renewal of plug-in type conduit box and nameplate.
 - 6) Chamfers applied to upper corners of the body.

【Details of Modification】

Details of modification are described hereunder.

1) Change of Mounting Bolt Length

IMPORTANT

The current 40 design series' body dimension from the gasket to the bolt fitting surface is 30mm. **The new 50 design series will be shortened to 25mm.** Due to this modification, the **mounting bolts will change from M6×40 to M6×35 (in case of single stack mount).**

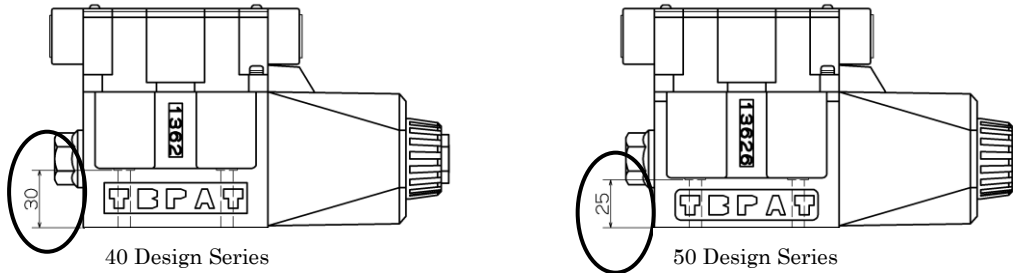

Figure 1: Change of Mounting Bolt Length

2) Change of Body's Surface Treatment

The current 40 design series has a 6-side surface treatment. The new 50 design series will have a 4-side treatment, **leaving the 2 sides with letters a casting surface.**

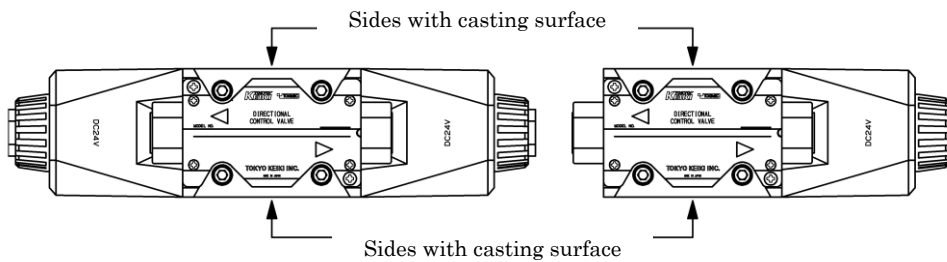
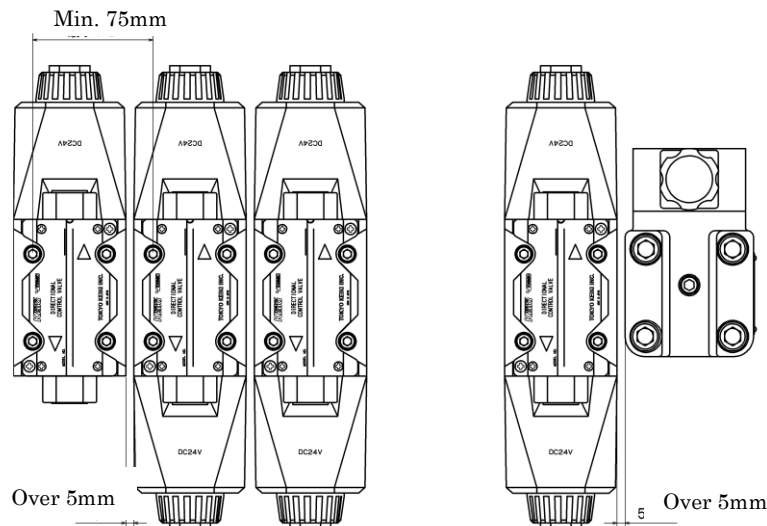

Figure 2-1: Change of Side Surfaces from Machined Surface to Casting Surface

The change will result in the body having tolerance of $\pm 1\text{mm}$ against the designed width (70mm). Please take into account the clearance when setting up valves closely together. (Please refer to following drawing.)



Horizontal installation of DG4V-5
(TGM-5 series stacking valves may be stacked)

Horizontal installation with other valves

Figure 2-2: Valve Installation Clearance

3) Removal of Sticker on Body

Due to change of body sides' machined surface to casting surface, **the sticker indicating the spool type with barcode will be removed.**

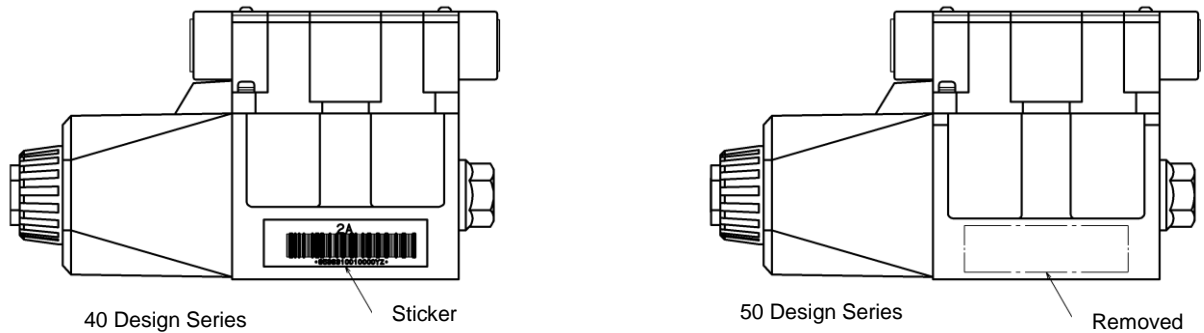

Figure 3: Removal of Sticker on Body Side

4) Change Position of Ground Screw Hole for the Conduit Box.

Due to renewal of the body's casting mold, **the position of ground screw hole has changed.**

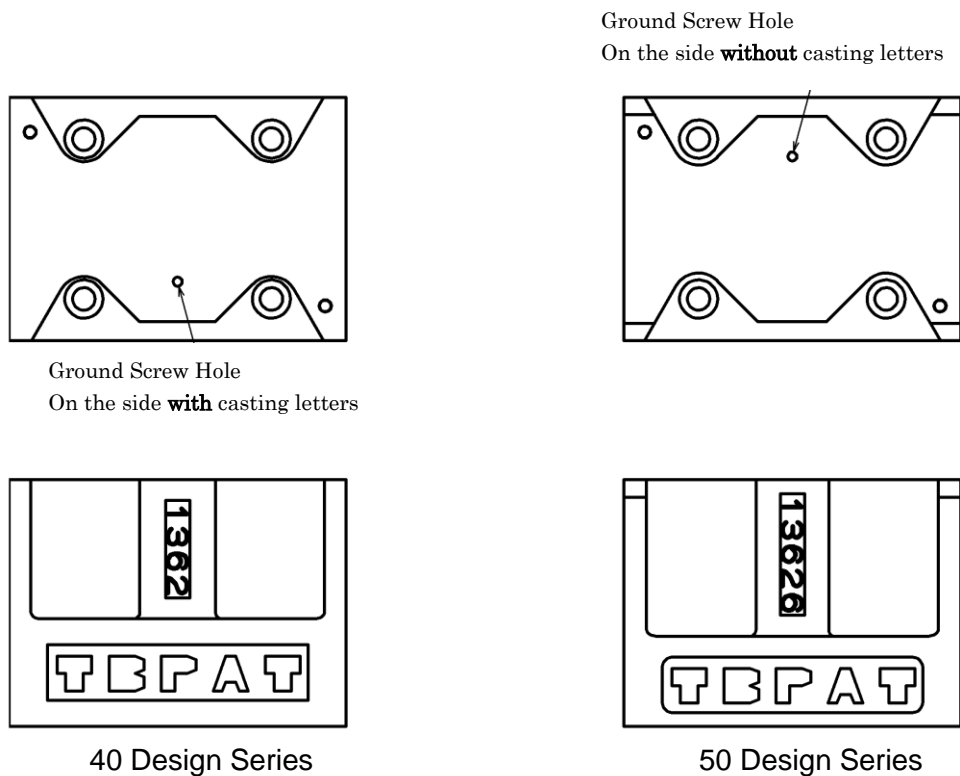

Figure 4: Position Change of Ground Screw Hole

5) Renewal of Plug-in Type Conduit Box and Nameplate

IMPORTANT

Due to position change of the body's ground screw hole, **the conduit box and nameplate have been renewed.**

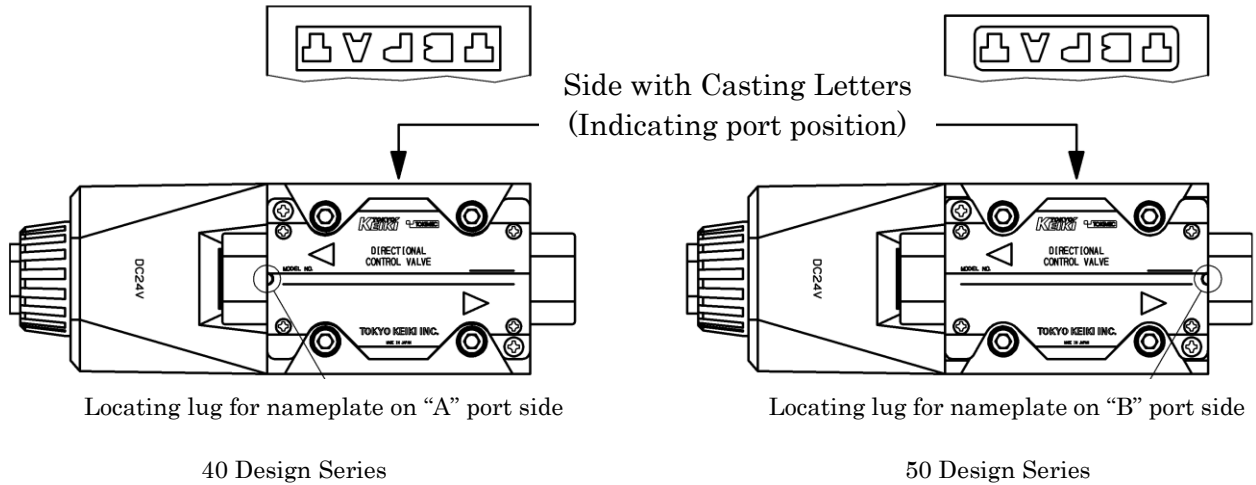

Figure 5: Renewal of Plug-in Type Conduit Box and Nameplate

6) Chamfers Applied to Upper Corners of Body

Due to update of the body's casting mold, **chamfers are applied to the upper corners of the body** (in "C5" size$5 \times 45^\circ$).

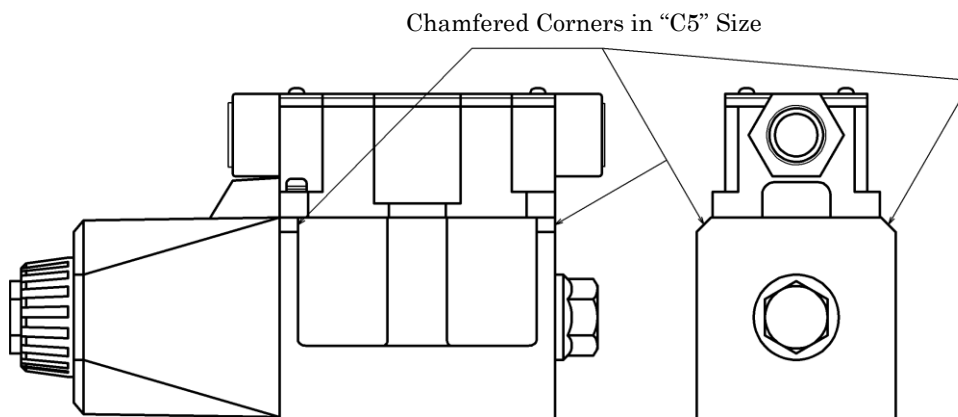

Figure 6: Chamfered Corners of 50 Design Series

【Product Release】

- The new 50 design series will be released from January, 2016.
- Please consult your relevant contacts for details.

【Dimension and Drawings】

- All other outer dimensions and mounting dimension of the new 50 design series will be the same as the current 40 design series.
- Please refer to your relevant contacts for if drawings are required.